



**Flexible solution, Reliable products**



**EG- Triplex/Quintuplex Plunger Pump**

## Fracturing Pump Fluid End

Our fluid ends are designed to get the job done. They are made from high-strength forged steel. For a smoother flow, each fluid end is precision machined at the intersecting bore with a unique combination of taper and radius. The internals are then polished for a finishing touch.

## Fracturing Pump Parts

The fracturing pump fluid end blocks and spares are 100% interchangeable to SPM, Gardner Denver, OFM, Serva, FMC.

We can supply the Spare Parts for the Pump Models as follow:

SPM	TWS250 、TWS400 、TWS600S 、TWS900 、QWS1000S、 TWS2500 、QWS3500 、TMP1650
FMC	WT2400,WQ2700,WQ3000
Gardner Denver	GD1600,GD2250,GD2500,GD3000
OFM	OFM600,OFM1000,OFM2000,OFM2250,OFM2500,OFM500W, OFM500WN,OFM600S,OFM2800Q,OFM2500Q
Serva	TPD600,TPH400,QPA1000,TPA2250,QPA2500

Frac Pump Fluid End drawing-For Quintuplex series- SPM2500

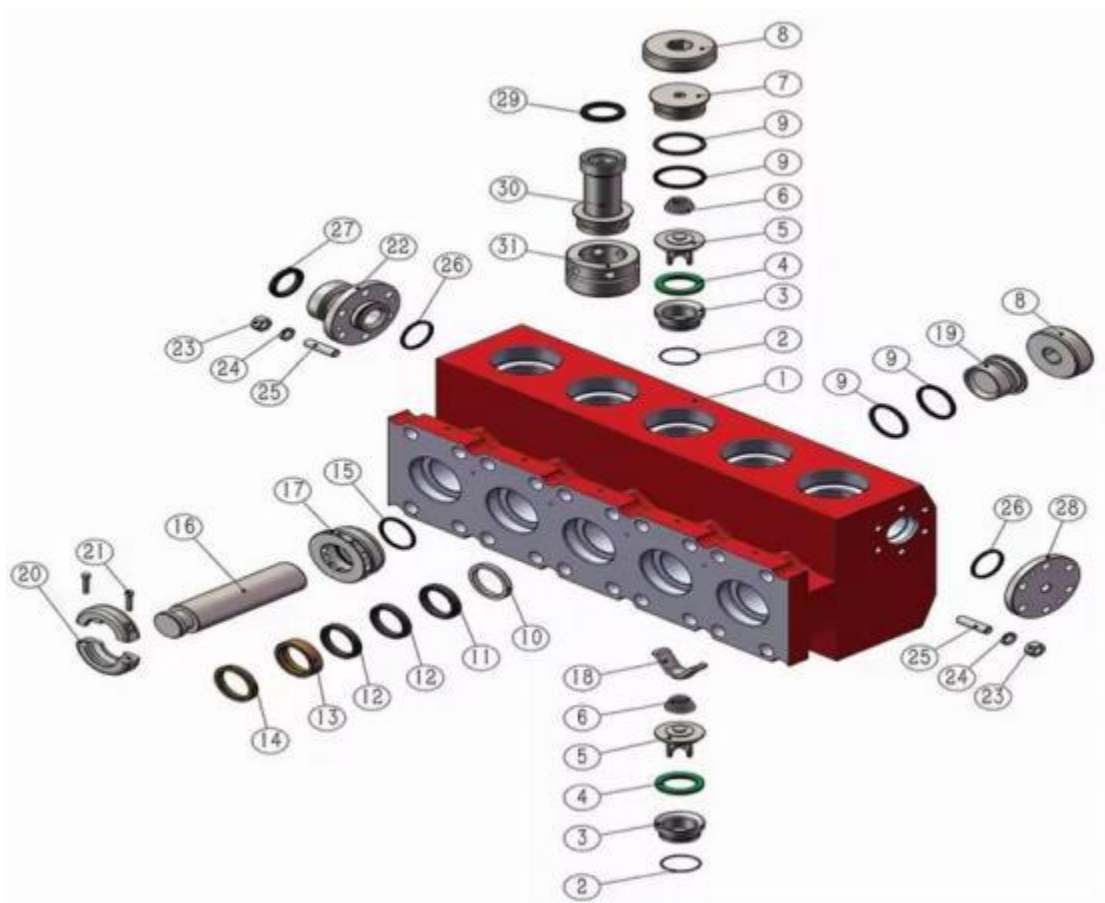

ITEM	DESCRIPTION	QTY
	Fluid end assy	1
1	Fluid end	1
2	O Ring or valve	10
3	Valve seat	10
4	Valve insert	10
5	Valve body	10
6	Spring	10
7	Discharge Block	3
8	Retainer Cover	10
9	Retainer block	20
10	Guide Ring	5
11	Rubber Packing	10
12	Febric Packing	10
13	Copper Sleeve	5
14	Oil Ring	5
15	Oil seal	5
16	Plunger	5
17	Packing Nut	5
18	Centering Rack	5
19	Side Block	5
20	Plunger Clamp	5
21	Clamp Screw	10
22	Flange, discharge	1
23	Flange Screw	12
24	Gasket	12
25	Double-head bolt	12
26	Plunger seal	2
27	Union seal, 3"	1
28	Flange, Pressure	1
29	Union seal, 2"	1
30	Sensor Block	1
31	Sensor Cap	1



## EG3-400 Triplex plunger pump

HT400 triplex plunger pump is a new type of horizontal single action, offset, reciprocating triplex plunger pump, which consists of three parts: the power end, gearbox, and fluid end, the maximum brake horsepower is 600BHP.

This pump has the advantages of small volume, large power, high pressure, large displacement, etc. This triplex pump is mainly used for cementing, fracturing, and acidizing equipment. It's the first choice for pressure cementing equipment.

### Specifications

Max Brake Horsepower	600 BHP (447KW)
Connection Rod Load(Max)	180,000lbf (800KN)
Stroke	8"(203.2mm)
Transmition	Turbine Drive
Speed Ratio	8.6:1
Size-LxWxH	77.36*39.44*46.81 in 1965*1002*1189mm
Weight	5500lb(2500kg)



### Fluid End

Item	Model	Specification	Weight	Material
Fluid end	HT400	4" 4.5"	480kg	4330V



## EG3-600S Triplex Plunger Pump

Model 600S is a classic pump developed from Practical experience and applicable for Fracturing, Cementing, Sand proof, acidizing, etc. small-scale fracturing operations. etc. This Pump is directly connected with the plunger and the cross head, reducing the pump's length so that it is widely used in a duplex double pump that looks good for cementing trucks or skids. The pump can be disposed of on the device so that the pipe layout is simple and, the operation is convenient.

### Specifications

Max Brake Horsepower	600 BHP (447KW)
Connection Rod Load(Max)	100,000lbf (445KN)
Stroke	6"(152.4mm)
Speed Ratio	4.6:1
Size-LxWxH	51.17*55.84*26.9 in 1299*1418*683mm
Weight	4600lb(2086kg)



### Fluid End

Item	Model	Specification	Weight	Size/mm LxWxH
Fluid end	600S	3.5" 4" 4.5"	526kg	715*489*298.5



## Quintuplex plunger pump, modle EG5-1000

Model 1000 Pump is directly connected with the plunger and the cross head which reduces the pump's length so that it is easy to layout on the device.

### Specification

Max Brake Horsepower	1000BHP(746KW)
Connection Rod Load (Max)	100,000lbf (445KN)
Stroke Length	6"(152.4mm)
Speed Ratio	4.61:1
Size-LxWxH	74.6*50.8*31.11 in 1895*1292*792mm
Weight	7231lb(3280kg)



### Fluid End

Item	Model	Specification	Weight	Size/mm LxWxH
Fluid end	1000	3" 3.5"	880kg	1171.97*503*297.5



## EG3-2250 Triplex Plunger Pump

2250 Triplex Plunger Pump commonly used for fracturing equipment. The double-gear transmission driving makes the equipment uniform force and improves the pump's stability and service life.

### Specification

Max Brake Horsepower	2250BHP(1,678KW)
Connection Rod Load(Max)	229,305lbf (1,020KN)
Stroke Length	8" (203.2mm)
Transmission	Double Cylinder Gear
Speed Ratio	6.353:1
Size-LxWxH	74.6*50.8*31.11 in 1895*1292*792mm
Weight	7231lb(3280kg)



### Fluid End

Item	Model	Specification	Weight	Size/mm LxWxH
Fluid end	TWS2250	4" 4.5" 5" 5.5"	1250kg	928*581*505





## EG5-2500 Quintuplex Plunger Pump

2500 Quintuplex Plunger Pump applicable for Fracturing, Cementing, Sand proof, acidizing, etc. Compared with the same rated power TWS pump, The pump's volume and weight increased a lot, but its displacement increased by nearly 1.7 times, so the work efficiency is much higher. The pump also adopts “人” shape tear reducer, its operation is stable and reliable.

### Specification

Max Brake Horsepower	2500BHP(1864KW)
Connection Rod Load(Max)	192,325lbf (855.5KN)
Stroke Length	8" (203.2mm)
Transmition	Double Cylinder Gear
Speed Ratio	6.353:1
Size-LxWxH	86.65*79.27*45.7 in 2201*2013*1161mm
Weight	16,093 lb(7,300kg)



### Fluid End

Item	Model	Specification	Weight	Size/mm LxWxH
Fluid end	QWS2500	3.5" 4" 4.5" 5" 5.5"	1650kg	1323*581*506



## EG5-2800 Quintuplex large power plunger pump

2800 Quintuplex large power plunger pump applicable for Fracturing, Cementing, Sand proof, acidizing, etc. The maximum pressure is up to 140MPa. This is a large power quintuplex plunger pump on the market. The modern design and penetrating type connecting bolts make the connection more reliable; the removable packing boxes make maintenance more convenient.

### Specification

Max Brake Horsepower	2800BHP(2088KW)
----------------------	-----------------

Connection Rod Load(Max)	229,305lbf (1020KN)
Stroke Length	8" (203.2mm)
Transmition	Double Cylinder Gear
Speed Ratio	6.333:1
Size-LxWxH	91.38*91.42*47.44 in 2321*2321*1205mm
Weight	20,900 lb(9,500kg)



### Fluid End

Item	Model	Specification	Weight	Size/mm LxWxH
Fluid end	SQP2800	3.75" 4"	2480kg	1600*519*609



# Frac Pump Workshop

## ISO & API standard

- Fluid-end workshop
- Components workshop
- Inserts workshop
- Heat treatment workshop



## Warehouse for all spare parts -Quick lead time



## Half-finished pumps



## Finished pumps All sizes are available





# EVERGROW

**Linhai Evergrow Petro Equipment Co., Ltd.**

Add.: #11 Tangyan South Road, Xi'an, China

Mob.: +86-185-103-311-91

Mail: [katya@linhaievergrow.com](mailto:katya@linhaievergrow.com)

Web.: [www.evergrowpump.com](http://www.evergrowpump.com)